

Features

- Compact 9mm design
- Carbon element
- Wide variety of mounting styles
- Center detent option
- RoHS compliant

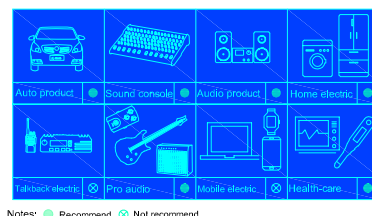

Notes: ● Recommend ○ Not recommend

RV90X Series-9.7mm Sealed Insulation Shaft Rotary Potentiometer

How To Order

RV90X22N0-FA30B12-B503-0000

A Rotary Potentiometer Model:90X
 C PC Pin Vertical/Terminal Size
 D Switch Configuration
N0=No Switch
 F Standard Shaft Length"L"
 H Installation Dimension"A"
 I Resistance Curve and Resistance Value
Resistance Curve To See:Tapers

Code	501	102	103	253	503	104	105
Value	500Ω	1KΩ	10KΩ	25KΩ	50KΩ	100KΩ	1MΩ

B Terminal Configuration(Pin Layout)
 E Shaft Style
 G Shaft Materials
B=Black Insulation Shaft
H=Gary Insulation Shaft
J=Golden Insulation Shaft
T=PELLUCID Insulation Shaft
 J Serial number

Mechanical Characteristics

Total Rotational Angle.....280°±10°
 Shaft Stopper Strength.....3Kgf.cm min.
 Shaft Wobble.....0.5 x L/20mm p-p max.

Rotational Torque.....10 to 100gf.cm
 Shaft Push-Pull Strength.....8Kgf 10s min.
 Soldering Condering.....
Manual Soldering.....96.5 Sn/3.0 Ag/0.5 Cu Sold Wire Or No-clean Rosin Cored Wire 280℃ Max.For 3 Seconds
Wave Soldering.....96.5 Sn/3.0 Ag/0.5 Cu Solder With No-clean Flux 260℃ Max.For 5 Seconds
Wash Process.....Not Recommended

Electrical Characteristics

Standard Resistance Range.....200Ω To 2MΩ
 Maximun Operating Voltage.....50 VAC,20 VDC
 Noise.....100 mV max.
 Voltage proof.....100V AC for 1 minute.
 Insulation resistance.....100MΩ min. 250V DC

Total Resistance Tolerance.....±10% Or ±20%
 Rated Power.....
Linear Taper.....0.05 Watts
Audio Taper.....0.025 Watts
 Residual Resistance.....20Ω max.

Environmental Characteristics

Operating Temperature Range.....-10℃ to +70℃
 Storage Temperature Range.....-40℃ to +85℃

Durability Characteristics

Rotational Life.....10,000 cycles

Tapers

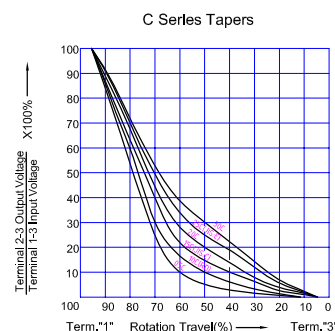
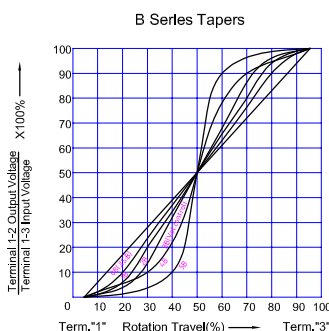
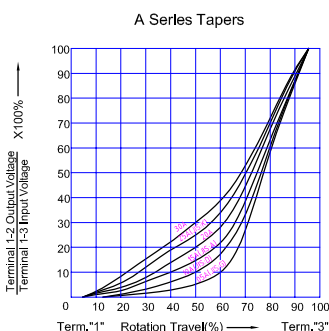

Product Dimensions

Unit:mm

RV90X12N0
RV90X22N0

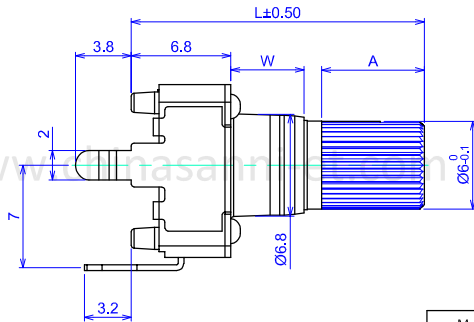

Model	W
RV90X12N0	1.60
RV90X22N0	5.00

Shaft shown in full CCW position

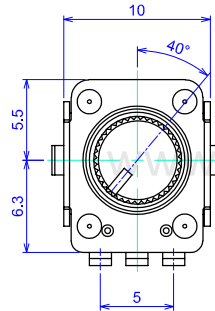

PC board mounting hole dimensions (Viewed from mounting side)

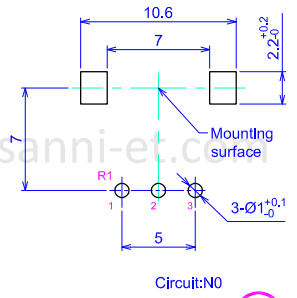

Circuit:N0



RV90XB2N0

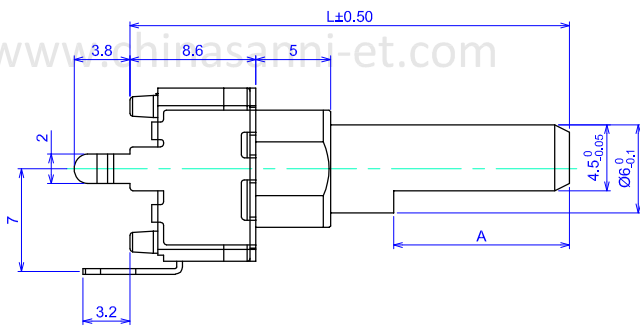

Shaft shown in full CCW position

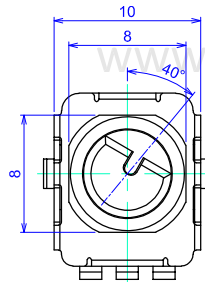

PC board mounting hole dimensions (Viewed from mounting side)

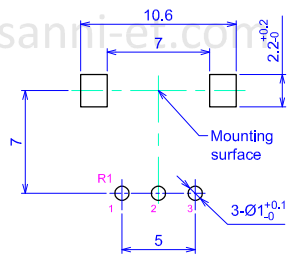

Circuit:N0



RV90XA2N0

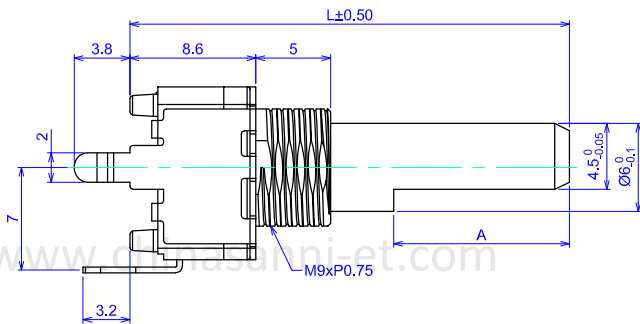

Shaft shown in full CCW position

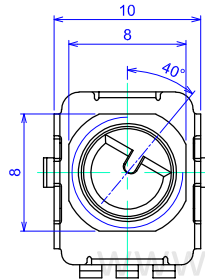

PC board mounting hole dimensions (Viewed from mounting side)

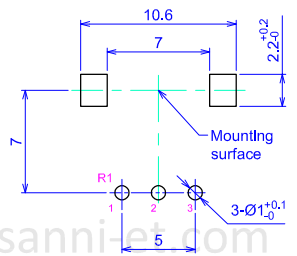

Circuit:N0



RV90X11N0
RV90X21N0

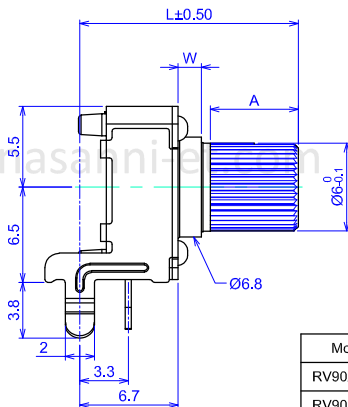

Model	W
RV90X11N0	1.60
RV90X21N0	5.00

Shaft shown in full CCW position

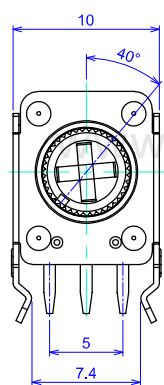

PC board mounting hole dimensions (Viewed from mounting side)

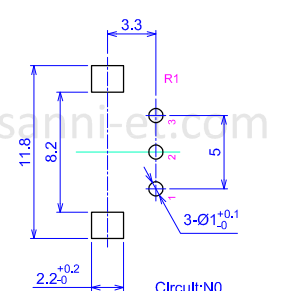

Circuit:N0



Product Dimensions

Unit:mm

RV90X13N0
RV90X23N0
RV90X15N0
RV90X25N0

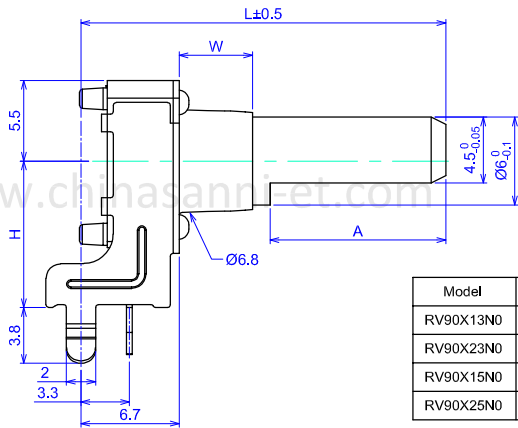

Model	W	H
RV90X13N0	1.60	10.0
RV90X23N0	5.00	10.0
RV90X15N0	1.60	12.5
RV90X25N0	5.00	12.5

Shaft shown in full CCW position

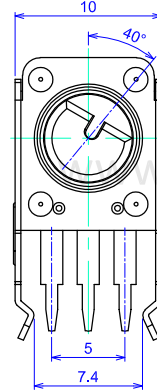

PC board mounting hole dimensions (Viewed from mounting side)

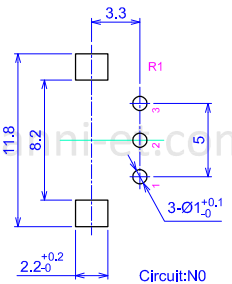

RV90XA1N0

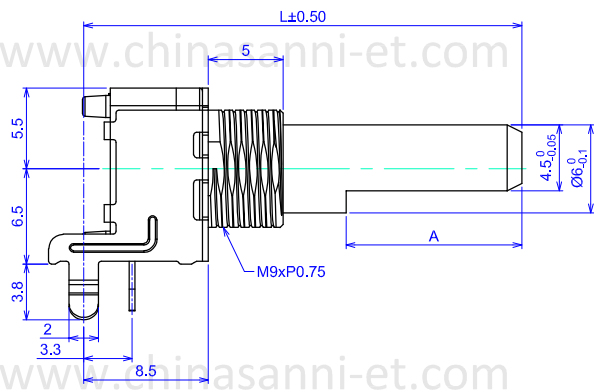

Shaft shown in full CCW position

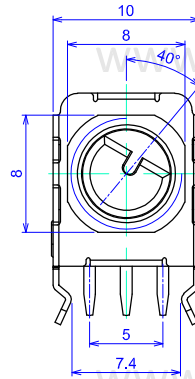

PC board mounting hole dimensions (Viewed from mounting side)

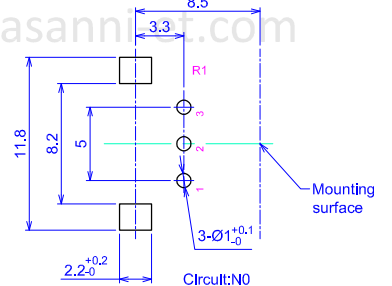

RV90XB3N0
RV90XB5N0

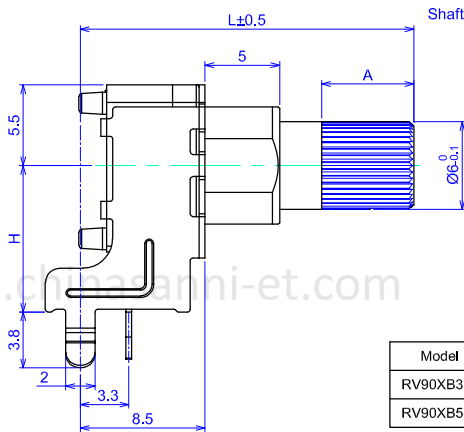

Shaft shown in full CCW position

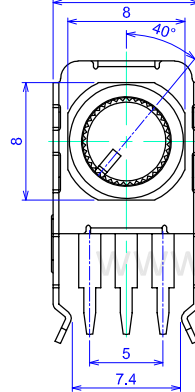

PC board mounting hole dimensions (Viewed from mounting side)

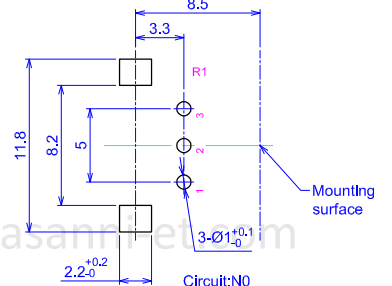

Mounting Hardware

Unit:mm

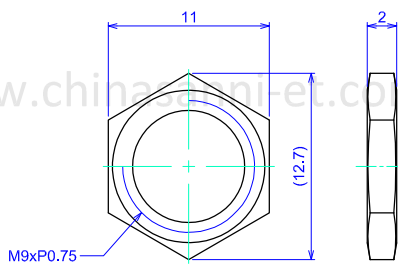

Nut

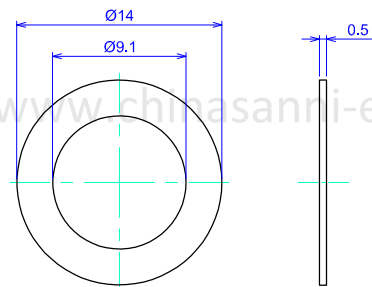

Washer

Shaft Specifications

Unit:mm

FA-Shaft Type		Detail Dimensions	TA-Shaft Type		Detail Dimensions
L	15 20 25 30 35		L	15 17.5 20 25 30	
A	6.0 7.0 12 12 12		A	6.0 7.0 7.0 7.0 7.0	
PB-Shaft Type		Detail Dimensions			
L	15 17.5 20 25 30				
A	6.0 7.0 7.0 7.0 7.0				

- ◆ Notes:
- Normal color for shaft is black.
 - Shaft length and color can be customized.
 - The shaft type shown are normal, if special shaft type needed, please contact with us.
 - Material for shaft is PC, if need other material please contact with us.